

Our Ref.: YL/TPN/2470B/L02

17 December 2024

Secretary
Town Planning Board
15/F, North Point Government Offices
333 Java Road, North Point
Hong Kong

By Post

Dear Sir/Madam,

**Planning Application for
A Temporary Storage of Construction Materials and Containers, Logistics Centre and
Ancillary Workshop for a Period of Three Years
at Lots 31802BRP(Part), 1807(Part), 1808RP(Part), 1819(Part), 1825(Part), 1826,
1827A, 1827B(Part), 1828(Part), 1829(Part), 1830(Part), 1831(Part), 1835(Part),
1836(Part), 1837, 1838, 1839(Part), 1843(Part), 1844(Part) and 1849(Part) in D.D. 125
Ha Tsuen, Yuen Long, New Territories
(Planning Application No. A/HSK/541)**

We refer to the captioned planning application.

We would like to clarify the followings:

- (a) There is a tree preservation and landscape proposal approved under previous planning application No. A/YL-HT/961 and the existing landscape and tree plantings remain unchanged and properly maintained.
- (b) There was an accepted fire service installations proposal under previous planning application No. A/HSK/105. Although the fire service installation works have not yet been fully completed as the water supply has not yet been approved by Water Supplies Department, the Applicant has provided most of fire service installations on site. A set of updated fire service installations proposal (i.e. identical to the previously approved) is provided herewith for submission.

Should you have any queries, please feel free to contact our Mr. Anson Lee at 2301-1869. Thank you for your attention.

Yours faithfully,
For and on behalf of
LANBASE SURVEYORS LIMITED

Anson Lee
Encl.
RK/AL

c.c.
DPO/TM&YLW (Attn.: Mr. tony Lam By Email)

FIRE SERVICE NOTES :

- 1 A MODIFIED HOSE REEL SYSTEM WITH A 2,000 L F.S. TANK SHALL BE PROVIDED TO THE SUBJECT BUILDINGS IN ACCORDANCE WITH PARA 5.14 OF THE CODE OF PRACTICE FOR MINIMUM FIRE SERVICE INSTALLATIONS AND EQUIPMENT 2012. HOSE REEL SHALL BE PROVIDED TO ENSURE THAT EVERY PART OF THE BUILDINGS WHERE CAN BE REACHED BY A LENGTH OF NOT MORE THAN 30M OF HOSE REEL TUBING.
 - 1.1 HOSE REEL SHALL BE PROVIDED AT POSITIONS AS INDICATED ON PLANS
 - 1.2 NO FIRE SERVICE INLET TO BE PROVIDED FOR MODIFIED HOSE REEL SYSTEM
 - 1.3 TWO FIXED FIRE PUMPS (DUTY/STANDBY) TO BE PROVIDED
- 2 FIRE ALARM SYSTEM SHALL BE PROVIDED IN ACCORDANCE WITH BS 5839-1:2002 + A2:2008 AND FSD CIRCULAR LETTERS NO. 1/2009 & 3/2010 & 2/2012. ONE ACTUATING POINT AND ONE AUDIO WARNING DEVICE TO BE LOCATED AT EACH HOSE REEL POINT. VISUAL ALARM SIGNALS TO BE PROVIDED. ACTUATING POINT SHALL INCLUDE FACILITIES FOR FIRE PUMP START AND AUDIO VISUAL WARNING DEVICE INITIATION.
 - 2.1 FIRE ALARM PANEL TO BE PROVIDED AND LOCATED INSIDE F.S. PUMP ROOM
- 3 SUFFICIENT EMERGENCY LIGHTING WITH 2 HOURS BACK UP BATTERY TO BE PROVIDED TO THE BUILDINGS IN ACCORDANCE WITH BS 5266: PART 1 AND BS EN 1838
- 4 SUFFICIENT EXIT SIGN / DIRECTIONAL SIGN TO BE PROVIDED IN ACCORDANCE WITH BS 5266: PART 1 AND FSD CIRCULAR LETTER NO. 5/2008
- 5 FIRE EXTINGUISHERS SHALL BE PROVIDED AS INDICATED ON PLANS
- 6 WHEN A VENTILATION/AIR CONDITIONING CONTROL SYSTEM TO THE AREAS/BUILDING IS REQUIRED TO BE PROVIDED, IT SHALL STOP MECHANICALLY INDUCED AIR MOVEMENT WITHIN A DESIGNATED FIRE COMPARTMENT
- 7 AUTOMATIC SPRINKLER SYSTEM SHALL BE PROVIDED TO THE ENTIRE BUILDING/STRUCTURE IN ACCORDANCE WITH LPC RULES INCORPORATING BS EN 12845:2015 AND FSD CIRCULAR LETTER 5/2020 EXCEPT E&M PLANT ROOMS. SPRINKLER SHALL NOT BE PROVIDED TO STANDALONE TEMPORARY TOILETS / OFFICES / STORES / GUARD HOUSE WHERE TOTAL FLOOR AREAS LESS THAN 230 SQUARE METRES. SPRINKLER SHALL NOT BE PROVIDED TO AREAS OF COVERED SHED AS THOSE ARE METAL STRUCTURE WITH 2 SIDES OPENING.
 - 7.1 HAZARD CLASSIFICATION: OH3
 - 7.2 STORED PRODUCTS AND CATEGORIES: CATEGORY (1)
 - 7.3 STORAGE CONFIGURATION: FREE-STANDING (ST1) & POST-PALLET STORAGE (ST2)
 - 7.4 STORAGE HEIGHT NOT EXCEEDING: 4M & 3.5M
 - 7.5 STORAGE SHOULD BE CONFINED TO BLOCKS NOT EXCEEDING 50 SQ M IN PLAN AREA FOR CATEGORY 1
 - 7.6 STORAGE BLOCKS SHOULD BE SEPARATED BY AISLES NO LESS THAN 2.4M WIDE
 - 7.7 ONE NUMBER 135,000 LITRES SPRINKLER WATER TANK TO BE PROVIDED AS INDICATED ON PLANS
 - 7.8 SPRINKLER PUMPS, SPRINKLER CONTROL VALVES AND SPRINKLER INLETS SHALL BE PROVIDED AS INDICATED ON PLANS
- 8 SECONDARY SOURCE OF POWER SUPPLY FOR FIRE SERVICE INSTALLATIONS TO BE PROVIDED BY CONNECTION BEFORE THE MAIN SWITCH WITH AUTOMATIC CHANGE-OVER DEVICE AND SATISFACTION OF THE DIRECTOR OF FIRE SERVICES
- 9 SMOKE EXTRACTION SYSTEM SHALL NOT BE PROVIDED WHEREAS THE AGGREGATE AREA OF OPENABLE WINDOWS OF THE COMPARTMENT EXCEEDS 6.25% OF THE FLOOR AREA OF THAT COMPARTMENT IN WAREHOUSES

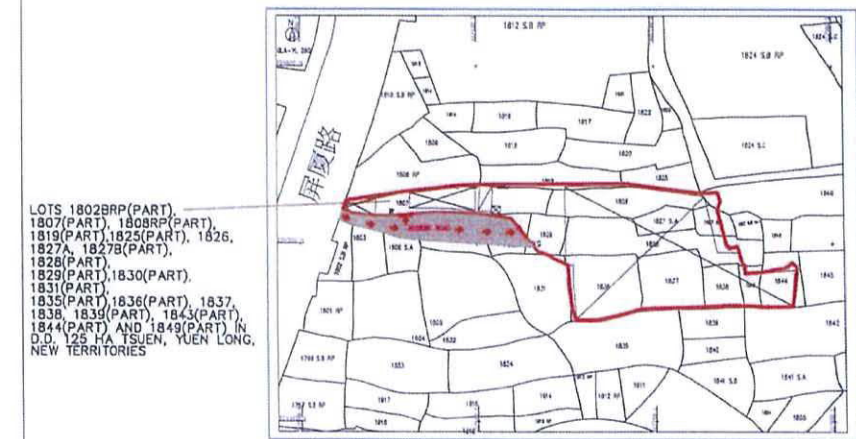
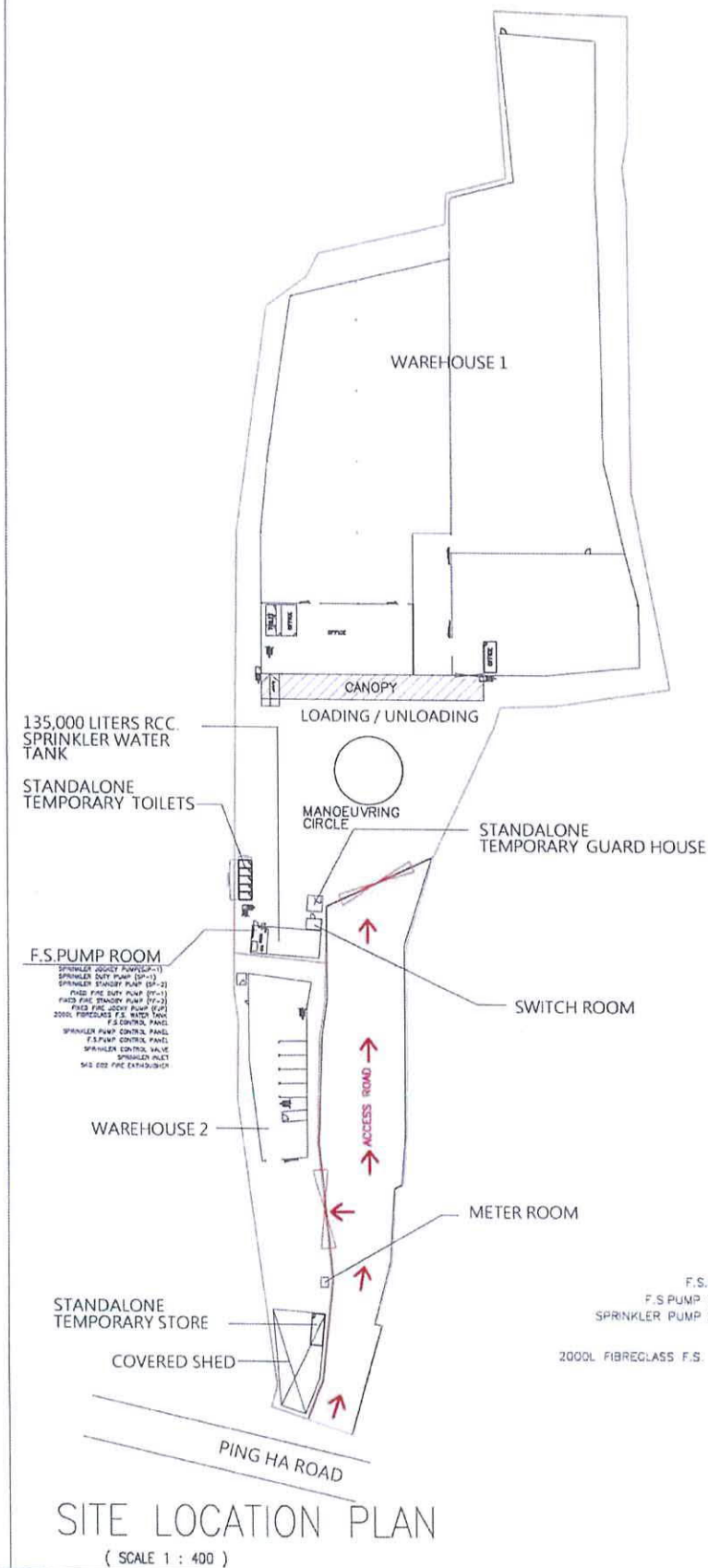

BLOCK PLAN (NOT TO SCALE)

LEGEND

- COVERED SHED
- METAL GATE
- FIRE ALARM BELL
- VISUAL FIRE ALARM
- MANUAL FIRE ALARM CALL POINT (BREAK GLASS TYPE)
- EXIT SIGN
- SLIDING DOOR
- HOSE REEL SET
- FIXED FIRE PUMP/SPRINKLER PUMP
- SPRINKLER CONTROL VALVE
- SPRINKLER INLET
- 9L W/ CO2 FIRE EXTINGUISHER
- SAND BUCKET
- 5KG CO2 FIRE EXTINGUISHER
- F.S. CONTROL PANEL
- SPRINKLER / F.S. PUMP CONTROL PANEL

FOR PlanD SUBMISSION

FSI CONSULTANT:



PROJECT:

LOTS 1802BRP(PART), 1807(PART), 1808BRP(PART), 1819(PART), 1825(PART), 1826, 1827A, 1827B(PART), 1828(PART), 1829(PART), 1830(PART), 1831(PART), 1835(PART), 1836(PART), 1837, 1838, 1839(PART), 1843(PART), 1844(PART) AND 1849(PART) IN D.O. 125 HA TSUEN, YUEN LONG, NEW TERRITORIES

TITLE: FSI NOTES, LEGEND, DETAIL OF F.S. PUMP ROOM, DETAIL OF STANDALONE TEMPORARY OFFICE, BLOCK PLAN AND SITE LOCATION PLAN

Planning Application No. A/HSK/541

SCALE: 1:400 @A0

DATE: 12/2024

DWG. NO: FS/01

CONTRACT NO.:

REVISION:

SHEET: 4

CHECKED BY: NG L.C.

DESIGNED BY: BARRY

DRAWN BY: BARRY

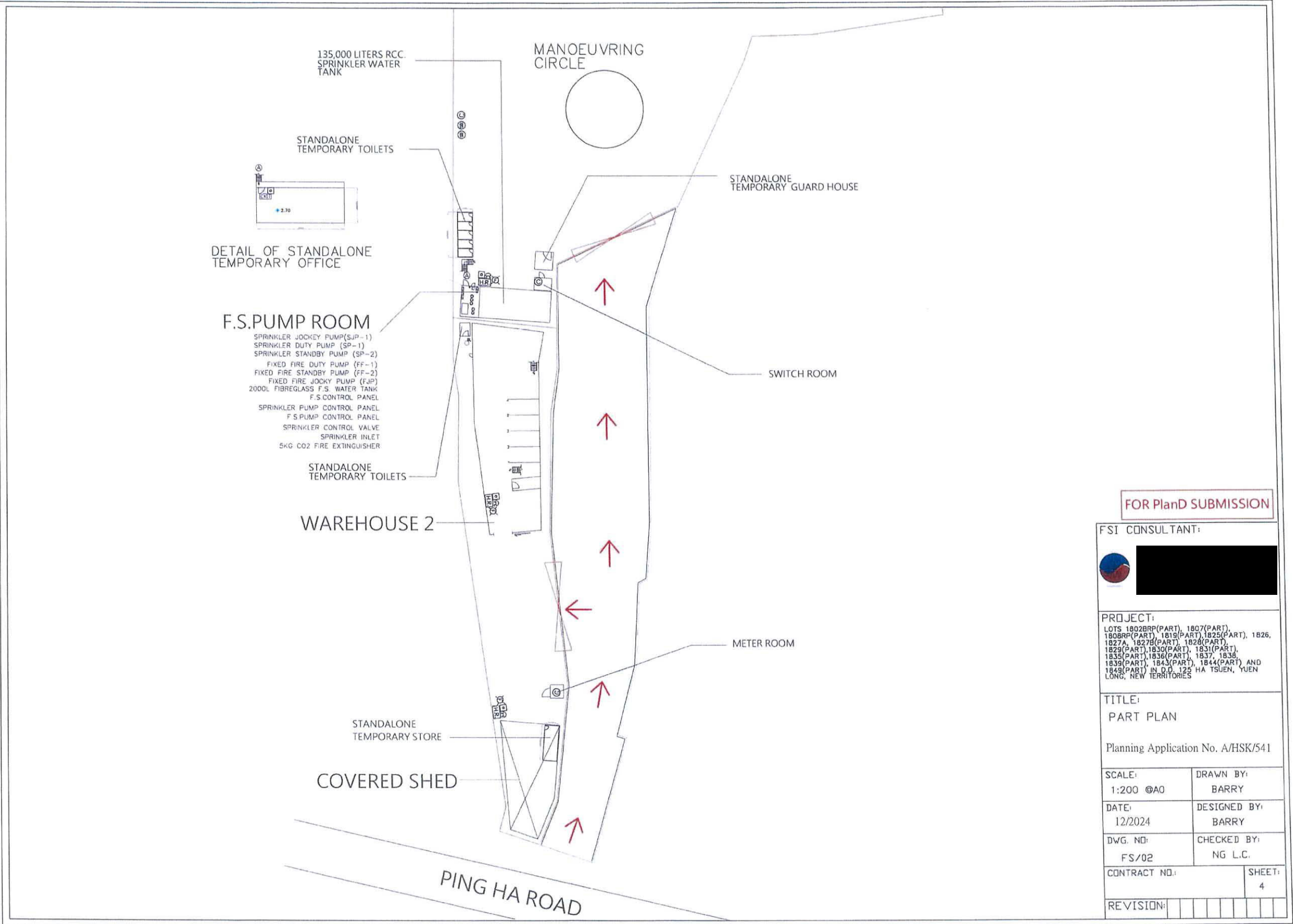

FOR PlanD SUBMISSION

FSI CONSULTANT:



PROJECT:
LOTS 1802BRP(PART), 1807(PART),
1808BRP(PART), 1819(PART), 1825(PART), 1826,
1827A, 1827B(PART), 1828(PART),
1829(PART), 1830(PART), 1831(PART),
1835(PART), 1836(PART), 1837, 1838,
1839(PART), 1843(PART), 1844(PART) AND
1849(PART) IN D.D. 125 HA TSUEN, YUEN
LONG, NEW TERRITORIES

TITLE:
PART PLAN

Planning Application No. A/HSK/541

| | |
|---------------------|------------------------|
| SCALE: 1:200 @A0 | DRAWN BY: BARRY |
| DATE: 12/2024 | DESIGNED BY: BARRY |
| DWG. NO: FS/02 | CHECKED BY: NG L.C. |
| CONTRACT NO.: | SHEET: 4 |
| REVISION: | |

